

# Calder Leisure

## XtremeLite

X-Treme Lite is designed with cutting edge technology, utilising a computer generated process to give you one of the finest and lightest fifth wheel trailers available.



X-Treme Lites are constructed of an aluminum frame and a fibreglass exterior for rugged durability year after year.

# Calder Leisure

## XtremeLite Features

### General

- Sleeps six
- 13,500 BTU ducted roof air conditioning
- 31,500 ducted warm air heating
- Full 240 Volt conversion
- 45 Amp power convertor - charger
- 8 X twin 13Amp sockets
- System monitor panel
- Electric front jacks
- Twin rear steady jacks
- Large front locker, 40 cubic ft.
- Ample interior storage
- All doors & windows have fly screens
- Roof vents
- Dead lock bolt on door
- Twin gas bottles
- Outside shower
- Fire Extinguisher
- Outside BBQ with plumbed gas supply
- Gas, CO2 & Smoke Detectors
- 14' awning
- Awning room available
- Foam insulation to R7 specification
- Spare tyre

### Bedroom

- Queen size bed
- Two large wardrobes
- Two bedside cabinets with drawers
- Fully carpeted
- Privacy curtain
- TV Aerial point
- Colour co-ordinated bedspread

### Lounge

- Sofa slide out
- Deluxe window treatments with mini blinds
- AM/FM CD Player
- TV point with signal booster
- 3 X Twin 13 Amp sockets
- TV Shelf
- Real oak doors
- Dining booth with storage underneath

### Kitchen

- 3-Burner Range with oven
- Microwave
- Stove hood with extractor fan & light
- Twin sinks with sink cover
- 8 Cubic ft. fridge-freezer
- 6-Gallon gas/electric hot water boiler
- 2 X 13 Amp twin sockets

### Bathroom

- Thetford flush toilet
- Mini bath with shower
- Vanity unit with mirror
- Large storage cupboard
- Extractor fan & roof vent
- Twin voltage shaver socket

# Calder Leisure

## XtremeLite Specifications

### XF23RBSL

|                                     |  |                        |   |
|-------------------------------------|--|------------------------|---|
| <b>Overall Length</b>               | 26'0"  | <b>Overall Width</b>   | 7'6"  |
| <b>Exterior Height</b>              | 8'6" + 12" for aircon  | <b>Interior Height</b> | 6'6"  |
| <b>Hitch Weight<br/>Axle Weight</b> | 995 lbs/450kg<br>3295lbs/1492kg  | <b>Dry Weight</b>      | 4290 lbs/1945kg   |
| <b># of Axles</b>                   | Double Dexter axles with Torflex suspension and four 12" brakes                      | <b>Tyre Size</b>       | 205x75x14"  |
| <b>Frame</b>                        | Powder coated box frame with steel outriggers to support walls                       | <b>Sidewalls</b>       | Aluminium framed with fibreglass exterior cladding with decorated ply interior wall board |
| <b>Floor</b>                        | 5/8 <sup>th</sup> " Plywood decking on a steel frame with carpet and vinyl coverings | <b>Roof</b>            | One piece vinyl seamless roof with a 12 year warranty                                     |
| <b>Fresh Water</b>                  | 31 gal   | <b>Waste</b>           | Grey 30 gal, Black 30 gal   |
| <b>Insulation</b>                   | Fibre glass wool to R7 specification   | <b>Battery</b>         | 1 X 85 Amp leisure battery  |

# Calder Leisure

## XF26RKSL

|                                     |  |                        |   |
|-------------------------------------|--|------------------------|---|
| <b>Overall Length</b>               | 27'4"  | <b>Overall Width</b>   | 7'6"  |
| <b>Exterior Height</b>              | 8'6" + 12" for aircon  | <b>Interior Height</b> | 6'6"  |
| <b>Hitch Weight<br/>Axle Weight</b> | 1045 lbs/473kg<br>3720 lbs/1685kg  | <b>Dry Weight</b>      | 4765 lbs/2158kg   |
| <b># of Axles</b>                   | Double Dexter axles with Torflex suspension and four 12" brakes                    | <b>Tyre Size</b>       | 205x75x14"  |
| <b>Frame</b>                        | Powder coated box frame with steel outriggers to support walls                     | <b>Sidewalls</b>       | Aluminium framed with fibreglass exterior cladding with decorated ply interior wall board |
| <b>Floor</b>                        | 5/8 <sup>th</sup> Plywood decking on a steel frame with carpet and vinyl coverings | <b>Roof</b>            | One piece vinyl seamless roof with a 12 year warranty                                     |
| <b>Fresh Water</b>                  | 31 gal   | <b>Waste</b>           | Grey 30 gal, Black 30 gal   |
| <b>Insulation</b>                   | Fibre glass wool to R7 specification   | <b>Battery</b>         | 1 X 85 Amp leisure battery  |

# Calder Leisure

## XF26BHSL

|                                     |  |                        |   |
|-------------------------------------|--|------------------------|---|
| <b>Overall Length</b>               | 27'4"  | <b>Overall Width</b>   | 7'6"  |
| <b>Exterior Height</b>              | 8'6" + 12" for aircon  | <b>Interior Height</b> | 6'6"  |
| <b>Hitch Weight<br/>Axle Weight</b> | 1090 lbs/493kg<br>3695 lbs/1673kg  | <b>Dry Weight</b>      | 4785 lbs/2167kg   |
| <b># of Axles</b>                   | Double Dexter axles with Torflex suspension and four 12" brakes                    | <b>Tyre Size</b>       | 205x75x14"  |
| <b>Frame</b>                        | Powder coated box frame with steel outriggers to support walls                     | <b>Sidewalls</b>       | Aluminium framed with fibreglass exterior cladding with decorated ply interior wall board |
| <b>Floor</b>                        | 5/8 <sup>th</sup> Plywood decking on a steel frame with carpet and vinyl coverings | <b>Roof</b>            | One piece vinyl seamless roof with a 12 year warranty                                     |
| <b>Fresh Water</b>                  | 31 gal   | <b>Waste</b>           | Grey 30 gal, Black 30 gal   |
| <b>Insulation</b>                   | Fibre glass wool to R7 specification   | <b>Battery</b>         | 1 X 85 Amp leisure battery  |

## Decor

Your Xtreme-Lite fifth wheel can be supplied with four different varieties of decor, as shown below:



Mood Indigo



Vintage Earth



English Pewter



Rustic Spice

# Calder Leisure

## Floor Plans

XF23RBSL

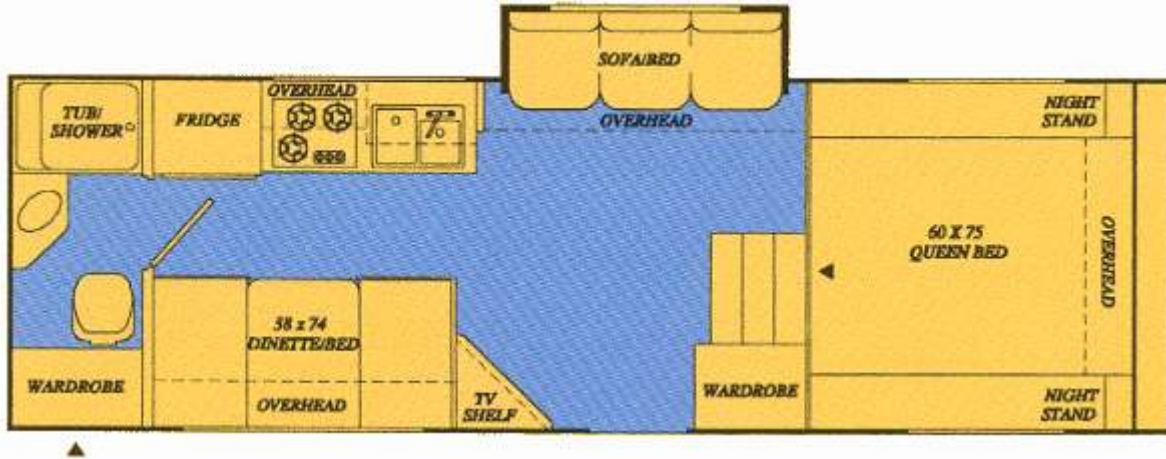

XF26RKSL

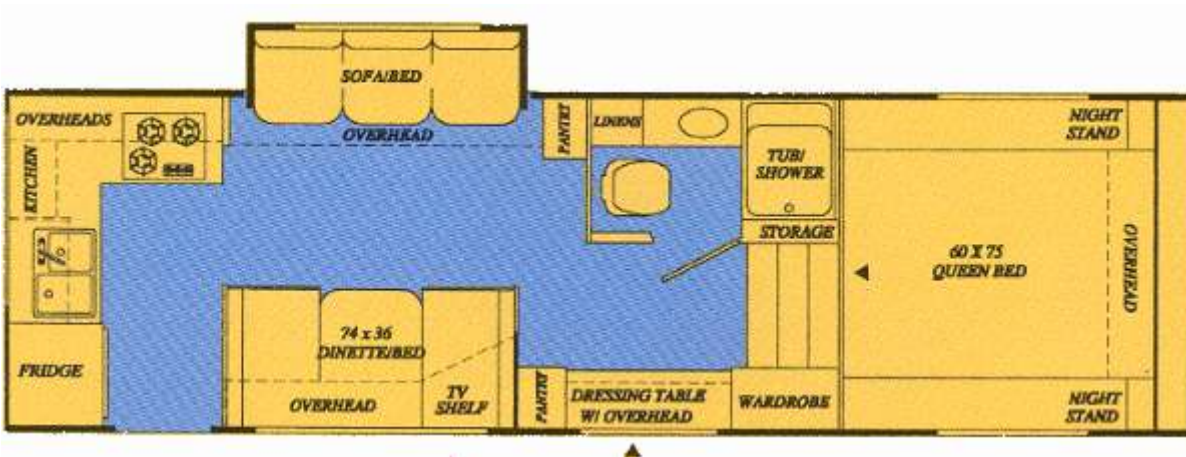

XF26BHSL

